

COVVI GLOVE REPLACEMENT GUIDE

DEFINITIONS

PPE | Personal Protective Equipment

ESD | Electrostatic Discharge

INFORMATION ICONS



STOP

Care Point Quality Control Check



Take ESD precautions

Wear ESD wrist strap and keep feet in contact with floor

SAFETY PRECAUTIONS

The glove and covers for the COVVI Hand should only be replaced following the enclosed instructions, and no other disassembly can be performed unless you have received training by a COVVI representative and received a certificate. COVVI Ltd. and COVVI USA INC have the right to void the warranty of all products that have any type of modification or damage caused by any unauthorised or untrained personnel.

- Damage caused during replacement of a glove by persons other than a COVVI representative is not covered by warranty unless the damage was inherent to the glove prior to receipt.
- Do NOT operate the COVVI Hand without the integrated glove as this could result in increased electromagnetic emissions or decreased electromagnetic immunity and result in improper operation.
- Do NOT use the COVVI Hand if a failure occurs, as it could cause damage to your patient or others.
- Do NOT interfere with the ESD shield. This is to protect the hand.
- Do NOT attempt to clean the internal components of the COVVI Hand.
- Cleaning of the glove should be limited to mild soap and a soft damp cloth. Do NOT use solvents, abrasive cleaners, etc.

DISPOSAL

The glove and its components must be disposed of in accordance with local regulations. There are no hazardous substances.

PROCEDURE - GLOVE REMOVAL

01. Remove 3 screws from back of hand using a T6 Torx driver and lift off metacarpus cover



Figure 1: Screws securing Metacarpus cover

02. Remove 4 screws from base of hand securing the wrist portion of the glove using a PH00 driver



Figure 2: 4 screws securing Base clip to wrist retention

03. Keep the Glove Base Clip (metal ring) - this will be required for refitment



Figure 3: Glove Base Clip

04. Separate the glove from the Wrist Retention ring. This is done by un-hooking the glove from the 4 screw positions



Figure 4: Unhook the glove from the bosses on the Wrist Retention Ring



Figure 5: Glove un-hooked

PROCEDURE - GLOVE REMOVAL

05. Slide the Wrist Retention ring off the base of the hand. It can be gently squeezed to allow it to slide over the wrist plate



Figure 6: Removal of Wrist Retention Ring

06. The Wrist Retention ring may be discarded if damaged. The glove pack has a replacement

07. Place fingers inside the wrist portion of the glove and start pulling the glove up towards the fingertips



Figure 7: Begin glove removal - hook over the button and base of thumb

08. Near the middle of the palm release the thumb by pulling the glove up and over so the thumb springs out

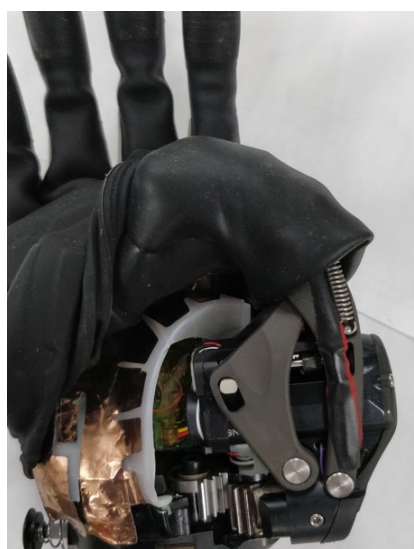

Figure 8: Pull up over thumb



Figure 9: Thumb tip removed from Glove

PROCEDURE - GLOVE REMOVAL

09. Pull the fingertips of the glove up so they release from the recesses in the fingers



Figure 10: Fingertips extended

10. Continue sliding the glove up from the palm upwards until the glove is fully removed from the hand
11. Check the hand to ensure nothing has been dislodged during the process

PROCEDURE - GLOVE FITMENT

01. Orientate the glove to match the position the glove and place fingers into wrist opening



Figure 11: Wrist opening

02. Stretch the glove over the fingers and GENTLY slide down



Figure 12: Glove over fingers

03. When the glove reaches the middle of the palm, check the fingers are aligned with the appropriate place on the glove

Care Point: Be careful not to catch the edge of the screen



Figure 13: Adjust so fingers align correctly

PROCEDURE - GLOVE FITMENT

04. Bend the thumb inwards and stretch the glove over the top, lining the tip of the thumb with the opening in the glove



Figure 14: Fold glove out

05. Slide the glove down towards the wrist, carefully checking the glove doesn't snag on anything on the way



Figure 15: Glove pulled down to wrist

06. Push each of the fingertips and the thumb tip down onto the end of the digits. They should slot into place and remain there



Figure 16: Press fingertips down on finger distals

06. Carefully massage the glove down so that it isn't stretched in any areas and the metacarpus holes roughly line up with the screw locations on the rear chassis of the hand



Figure 17: Glove position rear of hand

PROCEDURE - GLOVE FITMENT

08. Position the metacarpus cover, lining the screw holes up

- It is recommended to apply a small bead of Silicone Adhesive such as OPS100 around the screen cutout in the glove to maintain the IP44 rating

09. Secure the Metacarpus using the countersunk screws provided. If one screw is longer than the rest, this should be fitted to the screw position away from the screen

Care Point: Tighten to no more than 0.15Nm



Figure 18: Highlighted screw is the longest of the 3 (where applicable)

10. Hook the Wrist Retention ring over the wrist plate with the flanges pointing towards the fingertips

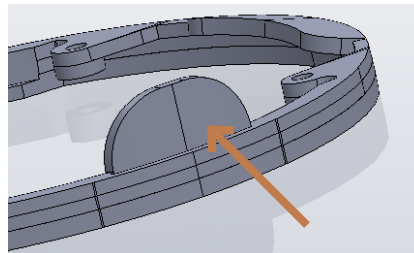

Figure 19: Wrist retention ring flange



Figure 20: Retention ring fitted over wrist plate

11. Using blunt tweezers, hook the small holes in the wrist of the glove over the bosses in the Wrist Retaining ring



Figure 21: Push the hole of the glove around the boss for the screws



Figure 22: All 4 hooked over ready

PROCEDURE - GLOVE FITMENT

12. Check the side flaps of the Wrist Retaining ring is over the lowest ridge of the glove

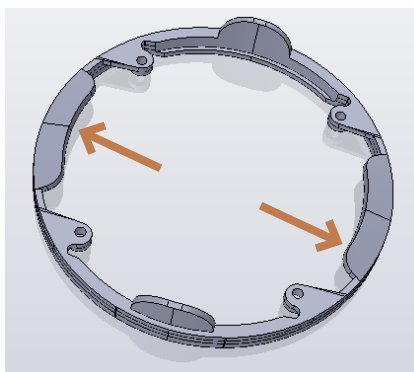

Figure 23: Side flaps of the Wrist Retaining Ring



Figure 24: Wrist retention ring side flap over ridge of glove

13. Hook the flange on the underside of the Wrist Retention ring over the small 'blades' on the Wrist plate

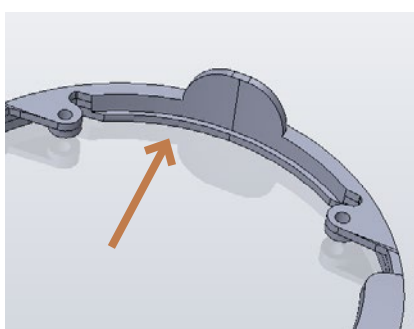

Figure 25: Underside flange of the Wrist retention ring



Figure 26: Wrist retention ring over wrist plate blade

14. Line up the Glove Base Clip (removed from the glove earlier)
15. Secure using the 4 self-tapping screws until the thread of the screw starts to appear through the top of the Wrist Retention ring



Figure 27: refitting the Glove Base Clip screws

16. Power on the hand and check all functions are working correctly
17. Clean the glove as per the instructions above



[instagram.com/covi](https://www.instagram.com/covi)



twitter.com/covi



[facebook.com/covi](https://www.facebook.com/covi)



[linkedin.com/company/covi](https://www.linkedin.com/company/covi)



Phone: +44 (0)20 3949 9500
Email: customerservice@covvi.com
Website: www.covvi.com



COVI Ltd.,
Unit 4 (Direct House),
Quayside Business Park,
Leeds, LS10 1DJ

v1.0.0

November 2022